



## Large Booth

Your quiet space for undisturbed phone calls and deep work.



### Tech Specs

#### Bureau Booth - Large

Capacity	1-4 Person including wheelchair accessible option
Internal Dimensions (mm)	2040w x 1550d x 2140h
External Dimensions (mm)	2200w x 1586d x 2300h
Glass Panels	Double laminated (6mm + 1mm + 4mm)
Door	855mm wide glass door with handle
Furniture Options	x2 upholstered bench seats with back & central laminated or veneer table; or x1 wall-mounted desk & task chair
GPO   USB   Data   Wireless Charging	Wall-mounted: 2x GPO, 1x USB C and x1 USB. Optional table top insert: x2 GPO, x2 USB, wireless charger
Lighting	1 x 16W LED – 3000k, CRI95+
Ventilation & Airflow	Variable speed fan with integrated acoustic cover
Lighting & Ventilation Operation	Motion sensor with variable speed fan control
Power Usage	30.4 watts
Weight	562kg
Acoustic Treatment	27mm bevel edge acoustic panels (dark grey). Acoustically treated exhaust port and acoustic cover to fan ports

# Large Booth / Furniture Options



**TABLE**

**Desktop**  
**Size:** (L 1000xW 550xH 760) mm. **Material:** Birch Plywood, Melamine faced fireproof board surface treatment: Edge Sealed with Wood Wax Oil. **Material Support:** Cold Rolled Steel Surface Treatment: Electrostatic Powder Coating.



**X2 SOFA**

**Composition:** 100% Polyester; Colour: Back rest Dark Grey 'Col. OL-40' and Seat Light Grey Col. OL-21'. **Manufacturer:** OTE Fabrics; Weight: 480g/m; Wight: 145cm; Durability: 40,000 Martindale; Lightfastness: 4-5; Pilling Resistance: 4-5 (ISO 12945).

## TABLE DIMENSIONS

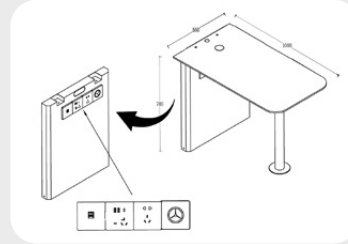

## SEAT DIMENSIONS

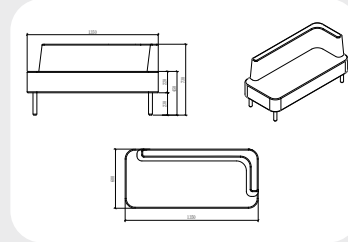

## Colors

### EXTERIOR

#### STANDARD



Cloud White

Domino Black



Orange Peel



Dove Grey



Sicilian Olive



Mist Green



Custom Colours

### INTERIOR



Acoustic PET Panel Dark Grey GP-04



Standard Dark Grey Felt FP1-1



OTE Fabrics (Standard) 100% Polyester OL-40



OTE Fabrics (Standard) 100% Polyester OL-21

### CARPET

## Features



**QUICK ASSEMBLY**



**PLUG-&-PLAY TECHNOLOGY**



**DOUBLE LAMINATED GLASS (6+1+4)MM**



**POWDER COATED GLASS EDGE**

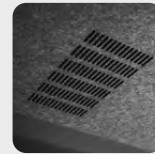

**INTEGRATED VENTILATION**



**OPTIONAL MOVING KIT**

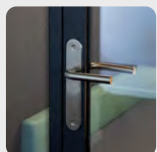

**ALUMINIUM LEVER DOOR HANDLE**



**ALUMINIUM FRAMED DOOR**



**INTERNAL SWITCHES & SENSORS**

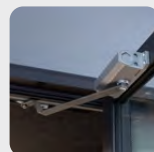

**HYDRAULIC DOOR CLOSERS**



**ABILITY TO PORT FIRE SERVICES**

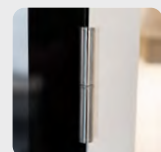

**ELECTROSTATICALLY COATED HINGES**

# Large Booth / Dimensions

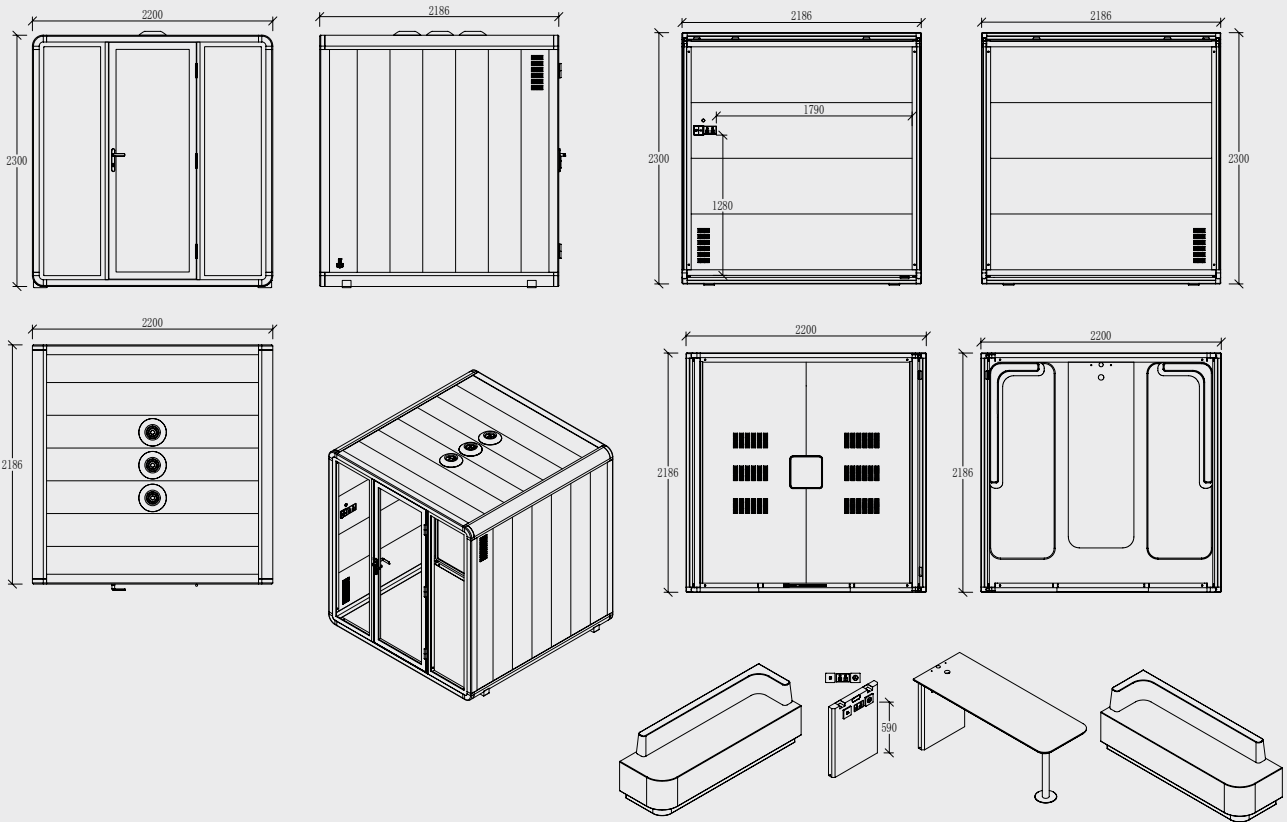

## Power

- INTERNAL** Integrated within wall below desk: 2x GPO, x1 USB C and x1 USB; Optional table below insert: x2 GPO, x2 USB, wireless charger; Manual switches for adjustable lighting and fan speed
- EXTERNAL** Allow 3m cable from back left corner
- SOFT WIRING** Standard AU power double GPO; Voltage: 110-220V/50Hz and 12V-USB power supply system

## Ventilation

- VENTILATION FAN** x1 Variable speed fan with acoustic cover; Diameter: 200mm, Silent and Built-in Ventilation System

## Acoustics

- SOUND REDUCTION** > 32 dB (Speech level reduction according to ISO 23351-1 testing method) 

## Download

3D MODELS AND  
RENDERS

INSTRUCTION  
MANUAL

BROCHURE

## Certifications

Accessible options; PET Fire Tested; ISO: 9001-2015 Quality Certified; ISO: 14001-2015 Environmental Certified; FSC Certified; AS/NZS 2208: 1996 Certified Glass; UL and CE Certified; Class B Certified Panels; Fire Growth Rate Index 153.2; ASTM E84-19A Tested; Flame Spread Index 15; Smoke Development Index 185

